

# Conference Room Seating Chart

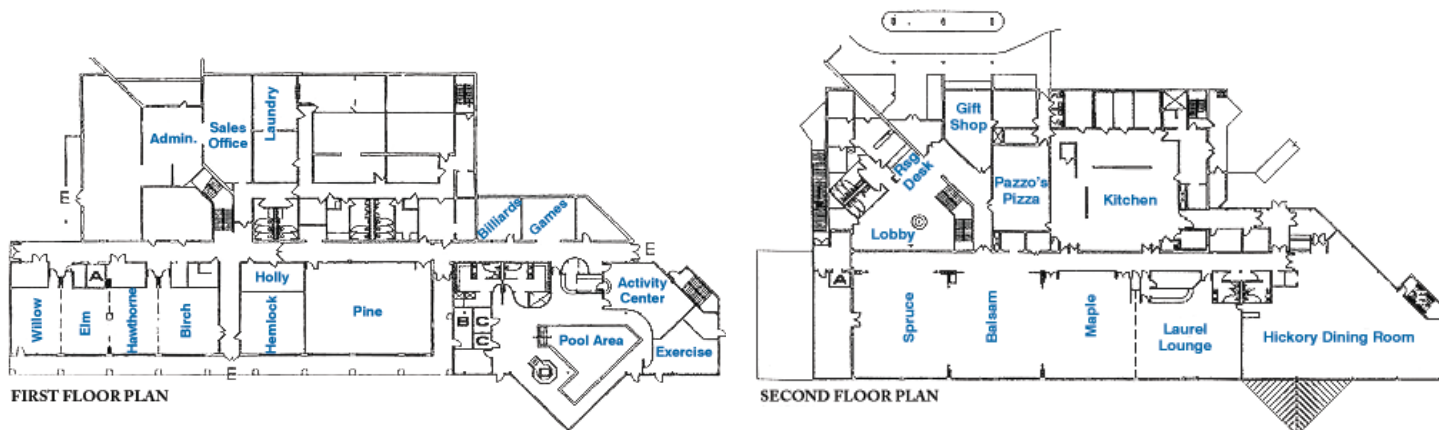

ROOM	"U"	Theatre	Class Room	Banquet	Reception	Board Room	Height	Width	Length	Sq. Ft.	Daily Cost
Maple	50	200	90	100-120	185	26	9' - 20"	38'	46'	1748	\$300
Balsam	50	200	90	100-120	185	26	9' - 20"	38'	46'	1748	\$300
Spruce	50	200	90	100-120	185	26	9' - 20"	38'	46'	1748	\$300
Pine	50	215	100	120-140	200	26	12'	52'	38'	1976	\$300
Birch	25	60	35	40-50	60	20	12'	24'	27'	648	\$100
Hawthorne	25	50	30	30-40	50	20	12'	20'	27'	540	\$100
Elm	25	50	30	30-40	50	14	12'	20'	27'	540	\$100
Willow	25	50	30	30-40	50	14	12'	20'	27'	540	\$100
Hemlock	25	50	36	40-50	60	20	12'	28'	26'	676	\$50
Holly	N/A	30	15	N/A	N/A	14	12'	12'	26'	312	\$25
Bear Paw	N/A	750	380	550	700	30	20'	90'	75'	6750	\$1,000
Pavilion	N/A	900	450	660	840	N/A	10'	50'	165'	8250	\$500

Please note that this chart does not reflect the addition of head tables, dance floors, water/break stations, a/v cart, etc. Wireless high-speed Internet access is provided at no charge in the lodge meeting rooms. All guest rooms are wired for free high-speed Internet.

### Audio-Visual Equipment Rental

35MM slide projector .....	\$25.00
LCD projector.....	\$150.00
27" TV and VCR.....	\$25.00
Podium & mic .....	\$10.00
Lavalier mic .....	\$15.00
Projection screen .....	FREE
Overhead projector .....	\$25.00
DVD.....	\$25.00

### Meeting Equipment Rental

Laser pointer .....	\$10.00
Flip chart with markers .....	\$10.00
Easel.....	\$5.00
Extension cords/power strips .....	\$10.00
AV cords.....	\$5.00
Direct phone line .....	\$100.00
Conference phone .....	\$150.00

### Conference Services

Copies.....	\$.20 each
Outgoing fax .....	\$5 First Page
	\$1.00 each additional page
Incoming fax .....	\$1 Per Page

### Special Arrangements\*

12'x12' dance floor rental.....	\$125.00
15'x15' dance floor rental.....	\$150.00
Tent set-up .....	\$250.00
Campfire.....	\$100.00
Hospitality set-up.....	\$150.00
Casino night set-up .....	\$75.00/table
	(Add \$25.00 for each dealer per hour)

\*Other special arrangements may be made through the Conference Service staff

### Exhibitor Fee

One 6' skirted table, 2 chairs,  
Electric \$5.00 extra  
\$25.00 per exhibitor / per day  
Phone service to exhibitor booth can be provided for an additional fee.

\*A 6% WV state tax and an 18% service charge will apply. All prices are subject to change due to availability or market price.